

SUPER FAST-CLEAN



NOZZLE SUPER FAST-CLEAN

Code 18270: SUPER FAST-CLEAN base UE 11/16x16

PISTON GUNSTOCK FILTERS

- Code 11039: Green (30M)
- Code 11038: White (60M)
- Code 11037: Yellow (100M)
- Code 11019: Red (200M)



- Compatible with all Airless guns
- Rapid replacement of working nozzle
- Rapid safe cleaning
- Maximum working pressure 350 bar (5075 psi)
- Long lasting carbon-tungsten insert
- Excellent finish

*Code-nozzle angle	Ø Inch	Ø mm	Product type	Filter recom.
SFC07-20	0,007"	0,18	Transp. and pigmented paints, thin enamels	Red 200 M
SFC07-40				
SFC09-20	0,009"	0,23		
SFC09-40				
SFC11-20	0,011"	0,28	Nitro, synthetic and polyurethane paints	Yellow 100 M
SFC11-40				
SFC13-20	0,013"	0,33		
SFC13-40				
SFC13-60				
SFC15-20	0,015"	0,38	Antirust	
SFC15-40				
SFC15-60				
SFC17-20	0,017"	0,43		
SFC17-40				
SFC17-60				
SFC19-20	0,019"	0,48	Primers, zinc inorganic, water paints	White 60 M
SFC19-40				
SFC19-60				
SFC21-20	0,021"	0,53		
SFC21-40				
SFC21-60				
SFC23-20	0,023"	0,58		
SFC23-40				
SFC23-60				
SFC25-20	0,025"	0,63	Thixotropic, stucco spray, high solid, paints with glue, fillers	
SFC25-40				
SFC25-60				
SFC27-20	0,027"	0,68		
SFC27-40				
SFC27-60				
SFC27-80				
SFC29-20	0,029"	0,74		
SFC29-40				
SFC29-60				
SFC29-80				
SFC31-40	0,031"	0,79		
SFC31-60				
SFC31-80				
SFC33-40	0,033"	0,83		
SFC33-60				
SFC33-80				
SFC35-40	0,035"	0,89		
SFC37-40	0,037"	0,94		
SFC39-40	0,039"	1,00		
SFC39-60				
SFC39-80				
SFC41-40	0,041"	1,05		Green 30 M
SFC43-40	0,043"	1,10		
SFC43-60				
SFC43-80				
SFC45-60	0,045"	0,15		
SFC47-60	0,47"	1,20		
SFC51-60	0,051"	1,30		
SFC51-80				

LARIUS
PAINT SPRAYING EQUIPMENT
www.larius.eu



AT300 AIRLESS GUN

M16x1,5

Code 11000

Professional gun at high pressure

1/4"

Cod. 11090



With device-Clean Super Fast

Ed. 004 09 - 11

MANUFACTURER:

LARIUS

23801 CALOLZIOCORTE - LECCO - ITALY - Via Antonio Stoppani, 21
Tel. (39) 0341/62.11.52 - Fax (39) 0341/62.12.43
E-mail: larius@larius.com - Internet http://www.larius.com



CUSTOMERS TECHNICAL SERVICE

Tel. (39) 0341/621256
Fax (39) 0341/621234

AT300 AIRLESS GUN

at high pressure

Pos.	Code	Description	Pos.	Code	Description
A	See table*	Nozzle Super Fast Clean	10	11024	Sleeve sealing
1	18270	Body Super Fast Clean	11	11025	Screw press sleeve
2	18280	Gasket Super Fast Clean	12	11026 +	Plate +
3	11004	Sleeve		11027	M3 nut
4	11005	Prick punch complete	13	11028	Spring
5	11008	Trigger gen	14	11029	Adjustment knob
5a	11010	Safety lever	15	11020	Gasket
5b	11011	Brake Washer	16	-	Filter
5c	11009	Trigger	17	11018	Handgrip
5d	11012	Pin	18	3085 +	Safety for hand +
5e	11013	Pin		11032	3 screws TSP 3x8
5f	11034/1	Pin	19	11017	Spring
5g	11027	Nut M3	20	32010	Copper washer
5h	11016	Washer	21	11015	Articulated joints M16x1,5
6	11007	Gun body		10155	Articulated joints 1/4"
7	11021	Pins			
8	11022	Spring Bauer 11x6x0.6			
9	11023	Wedge			

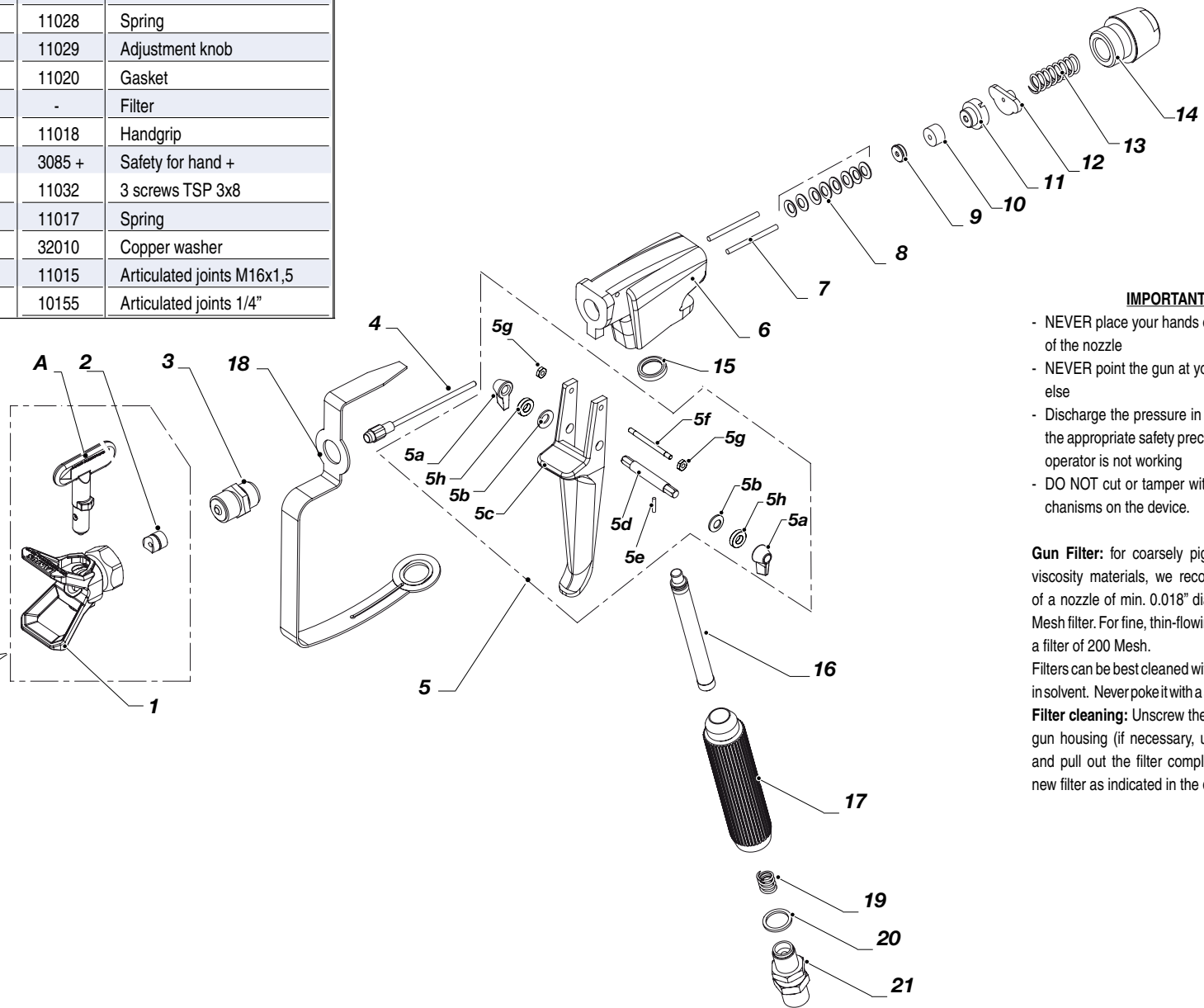

IMPORTANT!

- NEVER place your hands or fingers in front of the nozzle
- NEVER point the gun at yourself or anyone else
- Discharge the pressure in the gun and use the appropriate safety precautions when the operator is not working
- DO NOT cut or tamper with the safety mechanisms on the device.

Gun Filter: for coarsely pigmented or high viscosity materials, we recommend the use of a nozzle of min. 0.018" diameter and a 50 Mesh filter. For fine, thin-flowing materials, use a filter of 200 Mesh.

Filters can be best cleaned with a brush dipped in solvent. Never poke it with a sharp instrument.

Filter cleaning: Unscrew the handle from the gun housing (if necessary, use gun spanner and pull out the filter completely). Insert the new filter as indicated in the drawing.